

Kugelscheiben DIN 6319

Spherical Washer

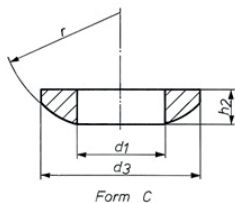

| Artikel Nr. Article No. | für Schrauben for Screws | Kugelscheibe C Conical Washer d1 | d3 | h2 | r |
|----------------------------|-----------------------------|--|----|------|----|
| 19c6,4 | M 6 | C 6,4 | 12 | 2,3 | 9 |
| 19c8,4 | M 8 | C 8,4 | 17 | 3,2 | 12 |
| 19c10,5 | M 10 | C 10,5 | 21 | 4 | 15 |
| 19c13 | M 12 | C 13 | 24 | 4,6 | 17 |
| 19c15 | M 14 | C 15 | 28 | 5 | 22 |
| 19c17 | M 16 | C 17 | 30 | 5,3 | 22 |
| 19c21 | M 20 | C 21 | 36 | 6,3 | 27 |
| 19c25 | M 24 | C 25 | 44 | 8,2 | 32 |
| 19c31 | M 30 | C 31 | 56 | 11,2 | 41 |
| 19c37 | M 36 | C 37 | 68 | 14 | 50 |
| 19c43 | M 42 | C 43 | 78 | 17 | 58 |
| 19c50 | M 48 | C 50 | 92 | 21 | 67 |



einsatzgehärtet